

PIT BULL® 412

Fusion Capability for 4" IPS to 12" DIPS (110mm - 340mm)



Pit Bull 412



Pit Bull 412 in 3-Jaw Configuration

OVERVIEW

Some fusions require a tough machine to get down and dirty. The Pit Bull® 412 is used in special applications where wheeled or tracked 412 machines are not needed. The machine is compact, while retaining many of McElroy's popular features.

FEATURES

- Patented Centerline Guidance System for equal distribution of force around the joint
- Industry-standard hydraulic control systems
- ISO-compliant industrial Teflon-coated plates
- Removable 3- or 4-jaw carriage for in-ditch use
- DataLogger® compatible
- On-board generator for powering heater and other devices
- Hydraulic pipe lift aids in loading and unloading pipe
- Serrated jaws & inserts keep pipe from slipping during fusion
- Thrust-bearing-equipped clamp knobs to minimize force required to clamp and round pipe
- Hydraulic facer for facing the heaviest wall pipe with ease
- Microprocessor-controlled heater

SPECIFICATIONS

CAPACITY

Fuses Pipe Sizes:..... 4" IPS – 12" DIPS (110mm – 340mm)

MODELS

AT1213002:.....High Cylinder Force, 240V, 50/60Hz, 1 Phase Input Voltage Req.

AT1213001:.....Medium Cylinder Force, 240V, 50/60Hz, 1 Phase Input Voltage Req.

AT1213003:.....Low Cylinder Force, 240V, 50/60Hz, 1 Phase Input Voltage Req.

WEIGHT

4-Jaw Carriage:..... 359 lbs. (163 Kg)

3-Jaw Carriage:..... 281 lbs. (118.4 Kg)

Facer:..... 62 lbs. (28.1 Kg)

Heater:..... 24 lbs. (10.9 Kg)

POWER

Heater Power:..... 3,000 Watt

Facer Power:..... Hydraulic

CHASSIS

Frame:..... Welded steel construction

HPU MODELS

T1810901:..... 240V, 60Hz, 1 Phase Input Voltage Req.

T1810902:..... 220-240V, 50/60Hz, 3 Phase Input Voltage Req.

HPU WEIGHT

Machine:..... 390 lbs. (176.9 Kg)

HPU HYDRAULICS

System Pressure:..... 1,500 PSI (103.42 BAR) Max.

Hydraulic Reservoir Capacity:..... 10 Gallons (37 Liters)

Pump Flow Rate 60 Hz:..... 6.1 GPM (23.1 LPM)

Pump Flow Rate 50 Hz:..... 5.0 GPM (18.9 LPM)

Fluid:..... Exxon Unisvis N46 or equivalent

Filtration:..... 10 micron absolute

HPU MOTOR

Electric:..... 5 HP

HPU POWER

Power Requirement:..... 5.2 KVA/4.5 Watt

HPU MOBILITY

Tires:..... High-flotation inflatable tires

Transportation:..... Two-wheel cart

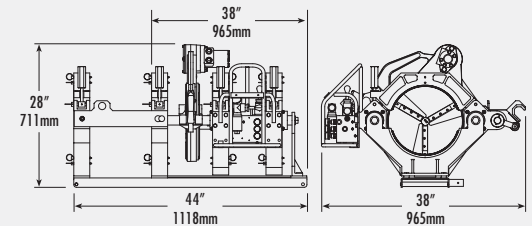

PIT BULL 412

INCLUSIONS

The Pit Bull 412 includes fusion machine, facer, heater, insulated heater stand and 12" IPS butt fusion inserts. Specifications are subject to change without notice.

